

# Instruction Manual XX258-80-00

## Introduction

The information in this manual covers the installation and setup of the V920-PH Pendant Housing for the Roughneck® V920D Fixed-Position Camera Domes. This unit should be installed by a qualified technician using common hand tools and approved materials and wiring methods in accordance with the national Electrical Code ANSI/NFPA 70, state and local wiring codes. Read these instructions through completely before attempting installation.

The V920-PH provides pendant mounting for the Roughneck V920D Series Fixed-Position Camera Domes. Refer to Installation and Operation Manual XX258 for V920D Camera Dome complete installation instructions. The pendant housing was designed for use with any mount that supports the total weight of the V920D and V920-PH. Refer to Installation and Operation Manual for the selected mount for specific mounting information.

## Installation

When the Roughneck V920D Dome Camera requires a pendant configuration, it must be installed in the V920-PH pendant housing. The mounting surface must provide suitable strength to support the weight of the V920D and the V920-PH combined, which is approximately 3.5 lb (1.6 kg). Be sure the area in the selected location is clear of obstacles (such as steel beams, headers, pipes, electrical wiring, etc.), which would interfere with mounting. Video and power cables must be routed to the location. Follow the steps below and refer to Figure 1.

1. Install the selected mount using appropriate hardware for the installation surface and run the cables through it according to the instruction manual for the mount.
2. Remove the lower dome/trim ring assembly from the base of the V920D by removing the four (4) screws.
3. An O ring is factory installed in the groove of the V920-PH.
4. Align the mounting holes in the base of the V920D with the mounting holes in the V920-PH and secure with the four (4) screws and lockwashers provided in the accessory kit. (Note: a magnetic screwdriver can be used for easier installation.)
5. Run the cables through the access hole in V920-PH and the V920D. Be sure to have sufficient cable length to complete wiring.
6. Apply pipe sealant provided to the threads of V920-PH to create a seal. Screw the V920-PH assembly onto the wall mount.
7. Wire the V920D; refer to XX258 (IP; XX258-10 for analog version) for complete instructions.
8. Continue with the instructions in the Roughneck V920D installation manual for camera configuration.
9. Reattach the lower dome/trim ring assembly.

Copyright © 2014 Vicon Industries Inc. All rights reserved.  
Vicon and its logo are registered trademarks of Vicon Industries Inc.  
Product specifications subject to change without notice.

**VICON INDUSTRIES INC.**  
TEL: 631-952-2288 FAX: 631-951-2288 TOLL FREE: 800-645-9116  
24-Hour Technical Support: 800-34-VICON (800-348-4266)  
UK: +44 (0) 1489 566300 WEB: [www.vicon-cctv.com](http://www.vicon-cctv.com)

SVFT-UWM  
(wall mount shown as a reference)

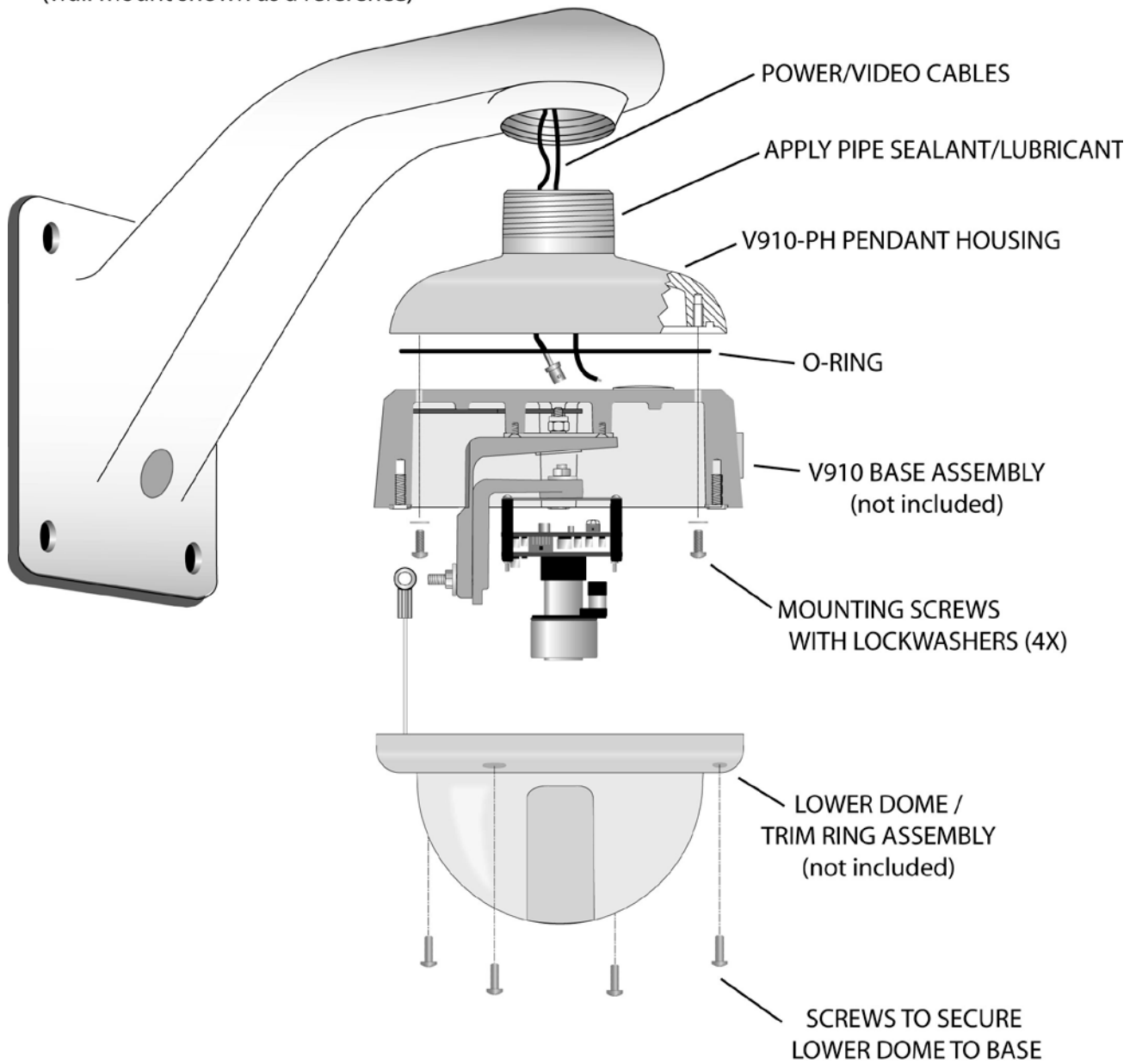

**Figure 1**  
**Installation Diagram Exploded View**

# **Vicon Industries Inc.**

**Internet Address: [www.vicon-security.com](http://www.vicon-security.com)**

